

Matters needing attention:

1. Please read the instructions carefully before installation;
2. Ask a professional electrician to install;
3. In order to avoid the danger of electric shock, please confirm to turn off the power supply before installation and maintenance;
4. Before installing the lamp, please ensure that the mounting surface is firm and reliable to avoid loosening and falling off the lamp.
5. Keep the manual for reference.

Installation of lamps:

1. Install plastic geckos on the ceiling, and reserve or process wire holes (plastic geckos in parts packages), as shown in Figure 1.
2. Remove the lamp from the packaging box, remove the round back cover of the lamp, fix the round back cover on the ceiling with self-tapping screws, and pay attention to the power cord when fixing

Through the cable holes on the round rear cover, as shown in Figure 2 and 3.

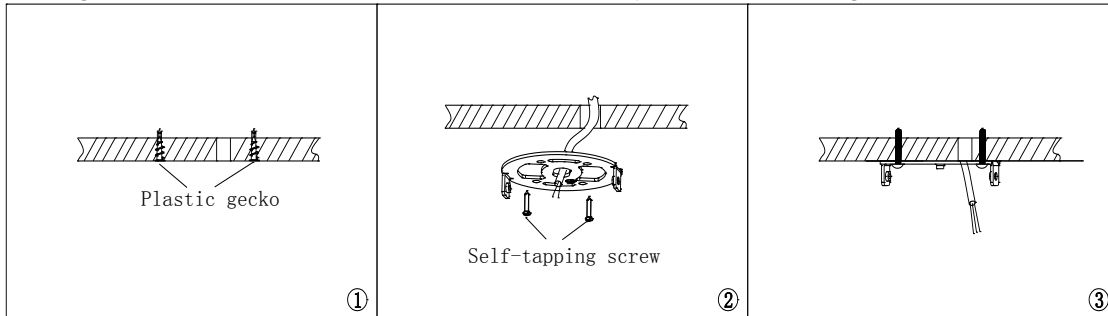

3. Connect the mains power input wire and the lamp power cord with the illustrated waterproof junction box (the illustrated waterproof junction box is not attached), as shown in Figure . Note: Yellow and green lines are ground lines (), live lines have "L" identification, zero lines have "N" identification, The positive pole of light modulation has a "+" identifier, and the negative pole of light modulation has a "-" identifier.

4. Install the luminaire: Align the luminaire with the round rear cover, push the luminaire up to the highest position, align the screw through hole on the top of the luminaire with the screw hole on the round rear cover, and screw in, as shown in Figure 5.

5. After fixing the screws, turn the middle lamp body, and the adjustable Angle lamp can rotate horizontally 0-355° and vertically tilt -25° to 25° , as shown in Figure 6.

The following version is fixed as shown in Figure 8.

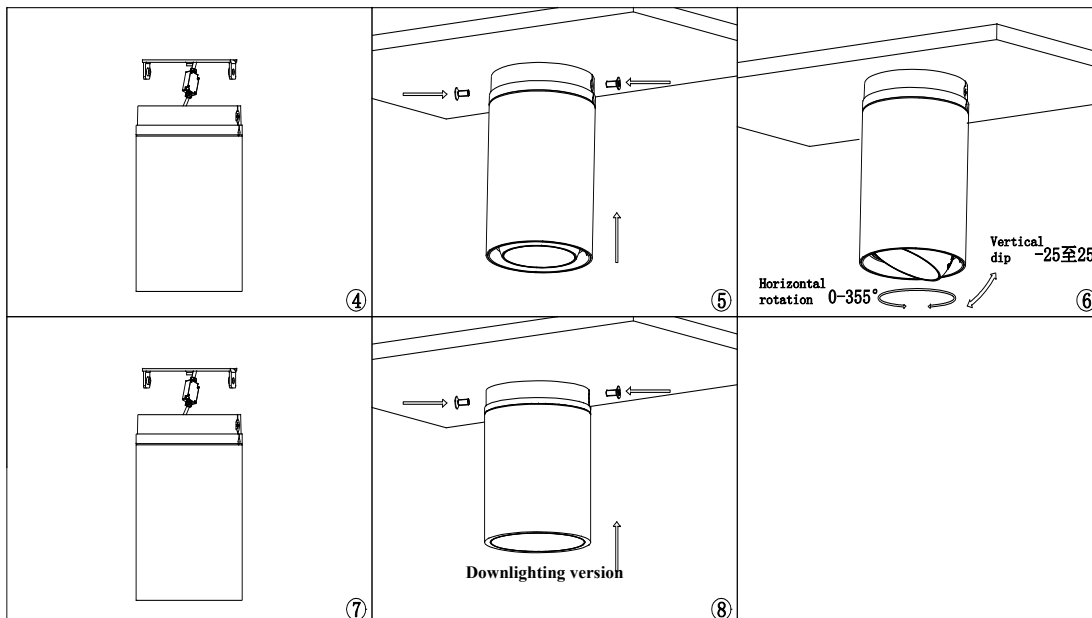

Installation declaration:

- 1、 Please read the instructions carefully before installation;
- 2、 Ask a professional electrician to install;
- 3、 In order to avoid the danger of electric shock, please confirm to turn off the power supply before installation and maintenance;
- 4、 The installation of lamps must comply with local laws and regulations.
- 5、 Keep the manual for reference.

Installation of lamps :

1. Select the M10 derrick of appropriate length and install it on the ceiling according to the actual situation on site, as shown in Figure 9 below (M10 derrick and nut are not attached).

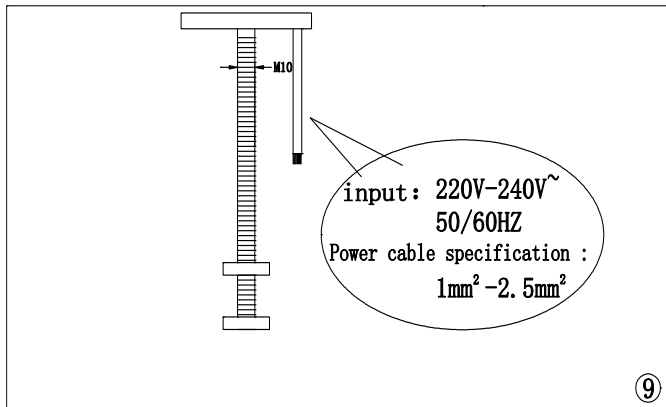

2. Install the lamp body into the derrick and lock the lamp with nuts; Connect the lighting cable to the ceiling power input cable with a waterproof junction box.

As shown below (waterproof junction box is not included).

Note: The yellow and green lines are ground lines (⊕), the live line is labeled with "L", and the neutral line is labeled with "N".

The dimming light is labeled with "+" and "-" respectively (dimming model only).

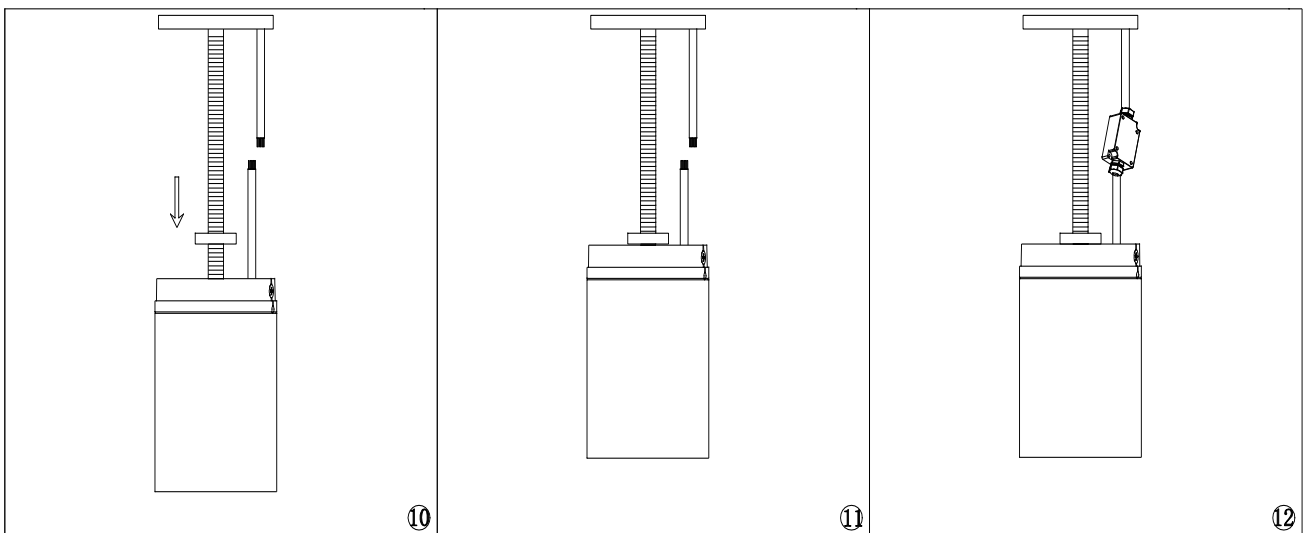

Licensed by "WAC" trademark holder - WAC LIGHTING, USA

Chinese Marketing Headquarters

: WAC Lighting (Shanghai) Co, Ltd.

Address

: 14.Lane 299, Bi Sheng Road, Shanghai 201204,China

China factory

: Manufactured WAC Lighting (Dongguan) Co, Ltd.

Address

: 390, Qingfeng Road, Qingxi Town, Dngguan, Guangdong. Postal code: 523653